

R-2530

STANLY COUNTY

NC 24-27

PROJECT
BREAKDOWN
MAP

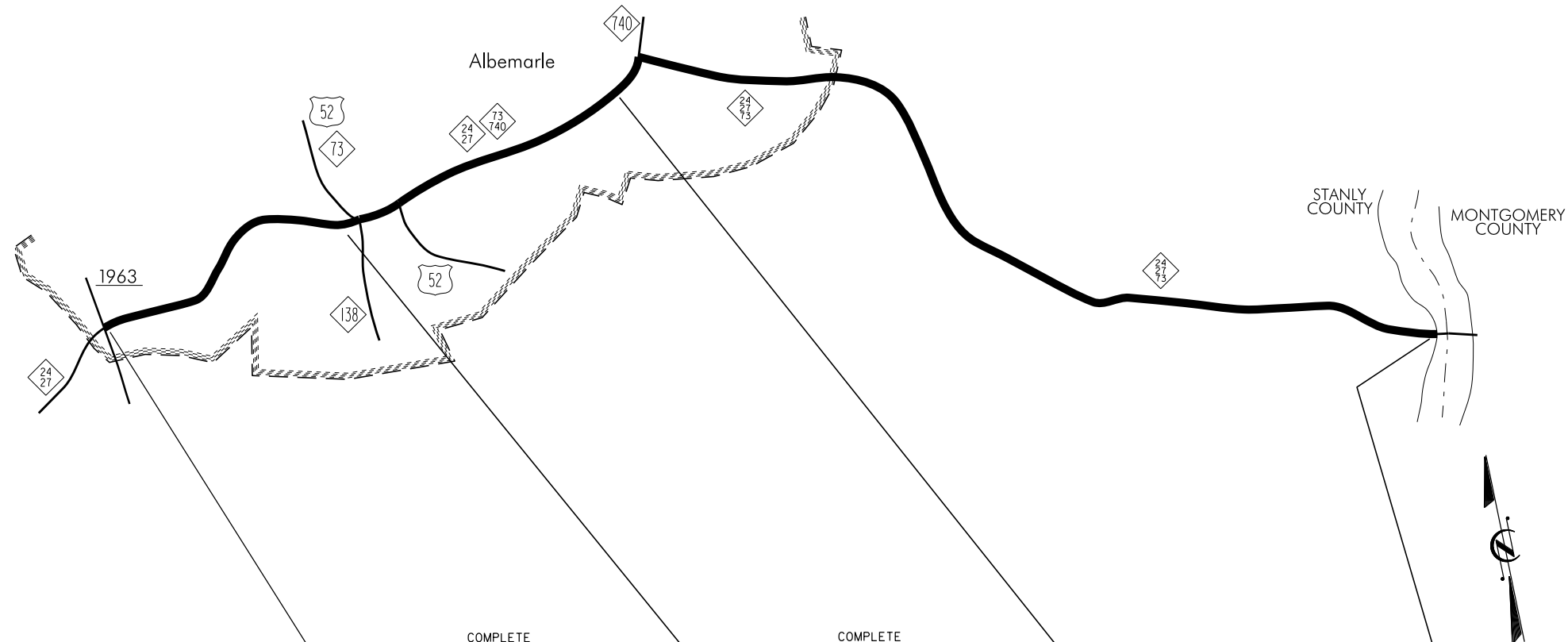

R-2530



	COMPLETE	COMPLETE	
I.D. NO. / D.S.R. NO.	R-2530 AA	R-2530 AB	R-2530 B
STATE PROJECT NO. (P.E.) / WBS*	34446	34446	34446
PROJECT ENGINEER	C. HOUSER	C. HOUSER	BREW
PROJECT DESCRIPTION	SR 1963 TO WEST OF US 52 IN ALBEMARLE	WEST OF US 52 IN ALBEMARLE TO NC 740	NC 740 IN ALBEMARLE TO PEE DEE RIVER
COUNTY / DIVISION	STANLY / DIV. 10	STANLY / DIV. 10	STANLY / DIV. 10
LENGTH	1.4 ML.	1.96 ML.	5.5 ML.
TYPE OF CONTRACT			
REMARKS			
BEGIN R/W ACQUISITION (T.J.P.)	10-98	10-98	FY 17
BEGIN R/W ACQUISITION (PRODUCTION)			
PROPOSED LETTING (T.J.P.)	12-00	10-00	FY 19
PROPOSED LETTING (PRODUCTION)			
EST. COMP. DATE (T.J.P.)	11-02	7-04	
ESTIMATED R/W COST / UTILITY COST	\$ 170,000	\$ 1,133,365	\$ 15,900,000
ESTIMATED CONSTRUCTION COST	\$ 7,400,000	\$ 13,700,000	\$ 29,200,000

PROJECT SCHEDULES AND COSTS ARE ACCURATE AS OF DATE SHOWN